

high pressure floors

installation in areas under water stress

Installation of BerryAlloc high pressure floors in areas under water stress

BerryAlloc high pressure floors can under certain circumstances be installed in areas under water stress. This document is particularly describing the precautions taken for such (water resistant) installations.

Installation precautions:

The edges of the floorboards must be added ClickGuard (art. no. 180012) or a similar non-curing transparent silicone. The requirements for non-curing silicone are described in the MSDS for ClickGuard.

Apply non-curing silicone on both the long and short side tongue so that the silicone squeezes up from the joint after connecting the floorboards (see illustrations below).

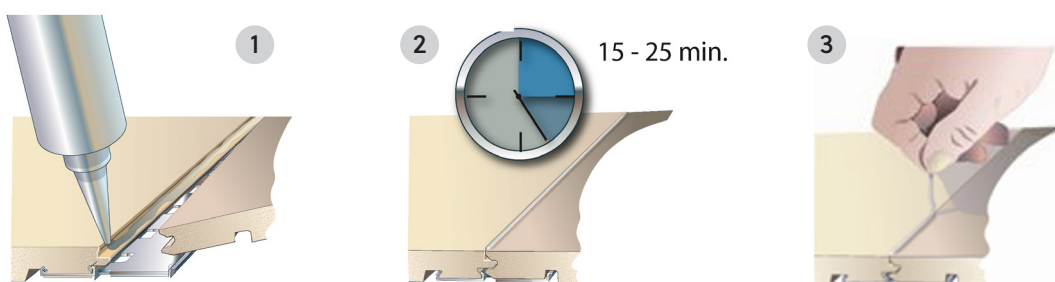

The subfloor must comply with the existing requirements for evenness (± 2 mm per 2 m). The subfloor must not slope. When installed on leveled subfloors including a drain, the underside of the edges of the drain itself must be filled with non-curing silicone.

The underside of the wall bases which are in contact with the surface of the floorboard must be added non-curing silicone in order to prevent water from leaking under the installed flooring. This also applies for other mouldings used for transmissions or endings.

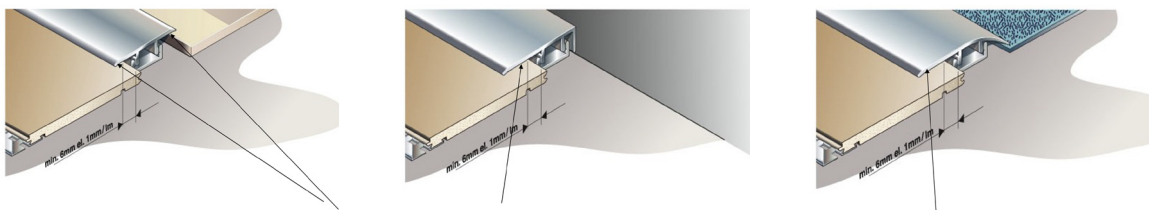

When mouldings are used, apply non-curing silicone on top of the surface which will be concealed by the moulding itself. Apply so much non-curing silicone that the silicone is squeezed out from under the moulding when mounting it. Wait 15-25 min and tear off the visible silicone (see picture 1, 2 and 3).

When drilled holes are made, the openings and pipe sleeves or covers shall be protected with non-curing silicone.

By following these instructions BerryAlloc High Pressure floors (HPF) can be installed for instance in:

- toilets
- laundry rooms with expected high moisture level
- restrooms outside saunas or next to swimming pools
- dressing rooms/wardrobes next to shower areas
- entrances

